



Our energy makes yours cleaner

IMPCO Europe Technologies develops, manufactures and markets custom-made systems and products that support the use of clean burning gaseous fuels and reduce emissions from internal combustion engines to the lowest levels.

Through the years, we have become an experienced partner for Original Equipment Manufacturers (OEM's) and our distributors. Due to our strong commitment to quality, we have built an experienced team dedicated to meet our customers needs as well as producing products in accordance with the high emission standards.

Our experience and dedication to the market have made us the leader in the material handling gaseous fuel industry in Europe. IMPCO Europe Technologies is ISO 9002 certified since 1994 and more recently received the ISO 9001 : 2000 certificate in 2001.

IMPCO EUROPE Tech. BV
Distributieweg, 9
2645EG DELFGAUW
THE NETHERLANDS

T + 31 15 274 2555
F + 31 15 274 2559

WWW.IMPCO-EUROPE.COM



MODEL 100 CARBURETORS

Natural, LPG and Digester gas

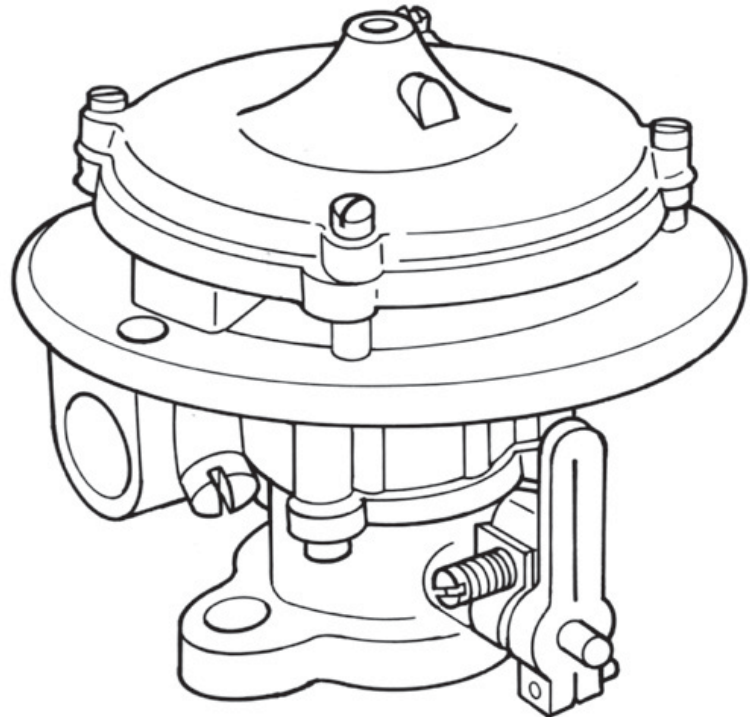

The model 125 Series is a single diaphragm air-gas valve carburetor mixer. It offers a downdraft air inlet that be can used for remote air filtration or open-element type air filters. This unit is available with several throttle body options.

The 125 series is available for propane, natural gas and digester gas applications.

The model 125 exists in 'FB' versions for Feedback application. The 100 mixer provides two separate air valve vacuum ports.

TECHNICAL DATA

Fuel	LPG, GNV, digester gas
Flow	110 l/s. (235 cfm)
Rating	until 108 kW (146hp)
Entrée air	from 66,7 to 80mm (option)
Flange	from 1" to 1-1/2" SAE
Body and cover	aluminium
Diaphragm	hydrin ou silicone

IMPCO 125 Series

Repair kits

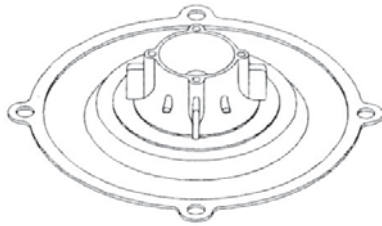

AV1-14-2
Hydrin diaphragm
7 on gas valve

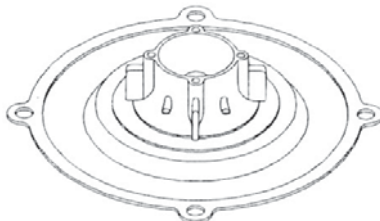

AV1-14-4
Silicone diaphragm
x on gas valve

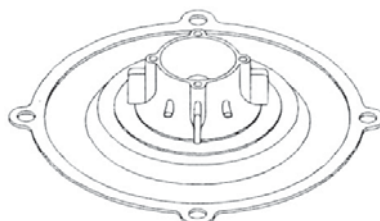

AV1-1447-279
Rich diaphragm for closed
loop system 47 on gas valve

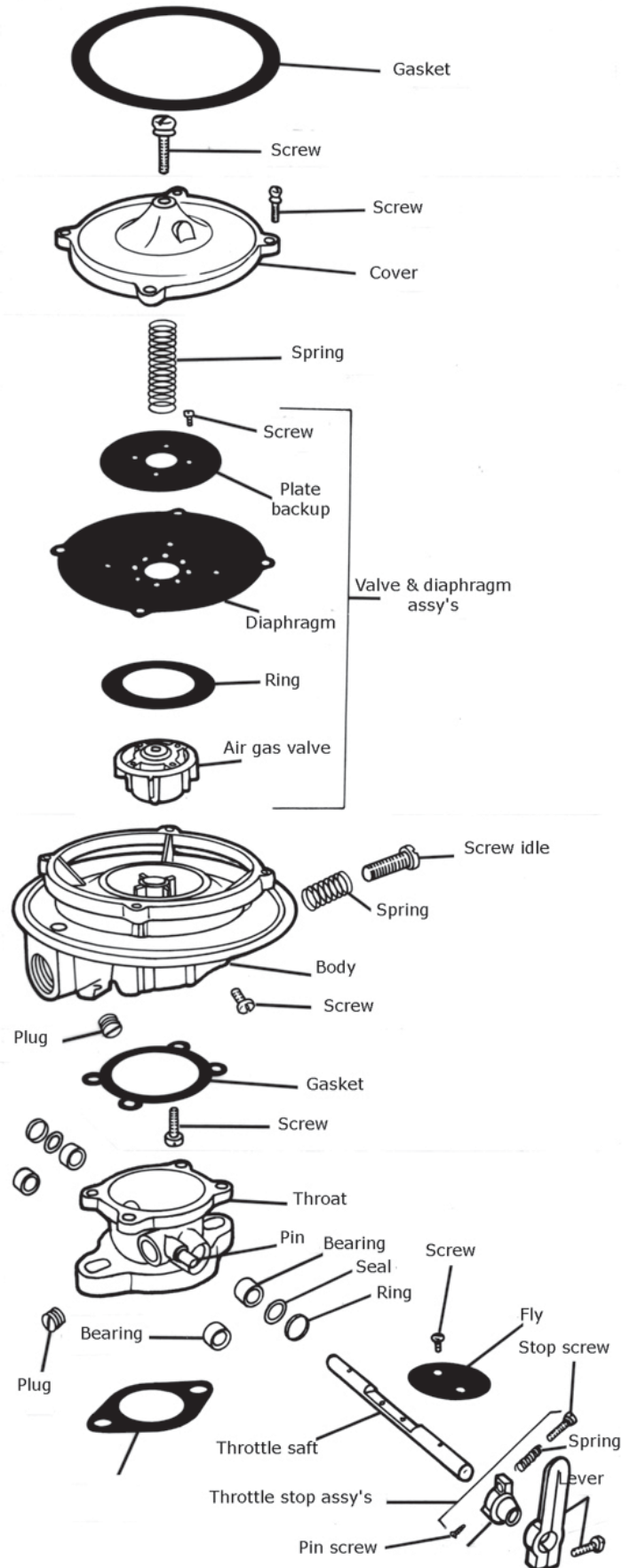

Other diaphragm, please ask